

DRAWING NUMBER
52/1147

PLAT OF

INDIAN WELLS

A P.U.D.

BEING A PORTION OF THE SOUTHEAST QUARTER OF SECTION 27,
TOWNSHIP 45 SOUTH, RANGE 42 EAST, PALM BEACH COUNTY, FLORIDA.

147

OCTOBER, 1985

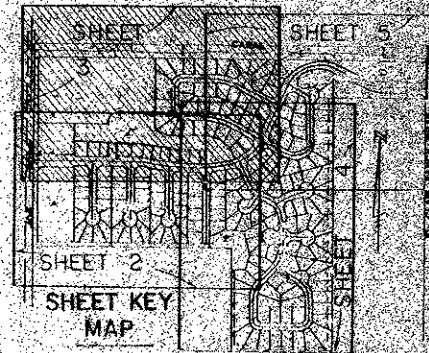
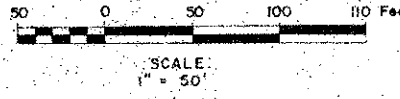

N.W. CORNER OF SE 1/4
OF SEC 27/45/42

P.O.B.

UNPLATTED

TRACT "E"

TRACT "E"

12 U.E.
DRAINAGE EASEMENT

12 U.E.
DRAINAGE EASEMENT

PARCEL C
RESERVED TO BE REPLATTED PRIOR
TO DEVELOPMENT

BENGAL

BENGAL

BLOCK 6

TRACT "F"

MAINTAINED BY HOMEOWNERS
ASSOCIATION

PARCEL B

MATCH LINE

MATCH LINE

INDIAN WELLS

BOULEVARD

SEE SHEET 2 OF 5 SHEETS

SUBDIVISION	Indian Wells
BOOK	Page 147
FLOOD ZONES	FLOOD MAP - 2.5
QUAD	3-5
SE	219.000

INDIAN WELLS

SHALLOW 52/1147

DRAWING NUMBER

DRAWING NUMBER

DRAWING NUMBER

PLANNED CORPORATION - IRVINE CALIFORNIA

PLANNED CORPORATION - IRVINE CALIFORNIA

PLANNED CORPORATION - IRVINE CALIFORNIA